

RECEPTACLE ASSEMBLY – MIL-C-24217/6 LOCKNUT FLANGE TYPE

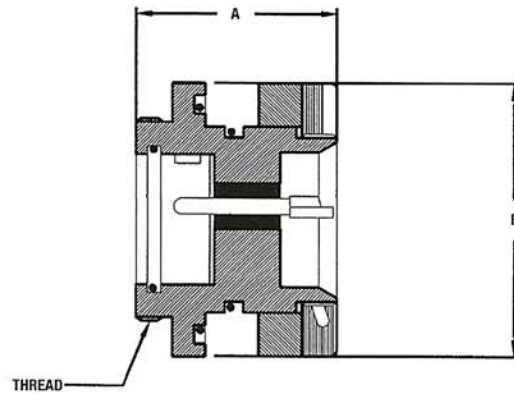

| AMETEK SCP PART NUMBER | MILITARY PART NUMBER | "A" DIM | "B" DIM | THREAD 2A | NO. OF PINS |
|---------------------------|-------------------------|------------|------------|--------------|-----------------------|
| CR1448-1 | M24217/6-001 | 1.62 | 1.87 | 1.250-12 | 3 EA. #16 |
| CR1448-2 | M24217/6-002 | 1.74 | 2.12 | 1.500-12 | 5 EA. #16 |
| CR1448-3 | M24217/6-003 | 1.87 | 2.25 | 1.750-12 | 9 EA. #16 |
| CR1448-4 | M24217/6-004 | 1.99 | 2.62 | 2.125-12 | 14 EA. #16 |
| CR1448-5 | M24217/6-005 | 2.12 | 3.12 | 2.500-12 | 24 EA. #16 |
| CR1448-6 | M24217/6-006 | 2.12 | 3.62 | 3.000-12 | 37 EA. #16 |
| CR1448-7 | M24217/6-007 | 2.41 | 4.37 | 3.750-12 | 48 EA. #16 |
| CR1448-8 | M24217/6-008 | 2.88 | 2.25 | 1.750-12 | 3 EA. #12 |
| CR1448-9 | M24217/6-009 | 2.88 | 2.62 | 2.125-12 | 5 EA. #12 |
| CR1448-10 | M24217/6-010 | 2.88 | 3.12 | 2.500-12 | 9 EA. #12 |
| CR1448-11 | M24217/6-011 | 2.88 | 2.62 | 2.125-12 | 3 EA. #8 |
| CR1448-12 | M24217/6-012 | 2.88 | 3.12 | 2.500-12 | 3 EA. #4 |
| CR1448-13 | M24217/6-013 | 2.88 | 3.12 | 2.500-12 | 3 EA. #12 3 EA. #8 |
| CR1448-14 | M24217/6-014 | 2.88 | 3.62 | 3.000-12 | 2 EA. #0 4 EA. #12 |
| CR1448-15 | M24217/6-015 | 1.59 | 1.87 | 1.375-12 | 8 EA. #16 |

CONFIGURATIONS AVAILABLE

Please refer to page 2.16 for above configurations available on the Receptacle Assembly – MIL-C-24217/6 Locknut Flange Type.