

AS85049/79 EMI/RFI Environmental Backshell



EMI/RFI
Environmental
Backshells

**Glenair Connector
Designator H**

**MIL-DTL-38999
Series III & IV,
EN3645**

M85049/79-11 W 01

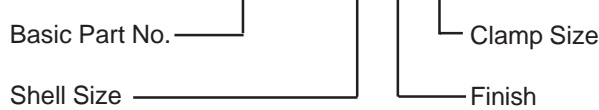

N = Electroless Nickel
W = 1,000 Hour Cadmium Olive
Drab Over Electroless Nickel

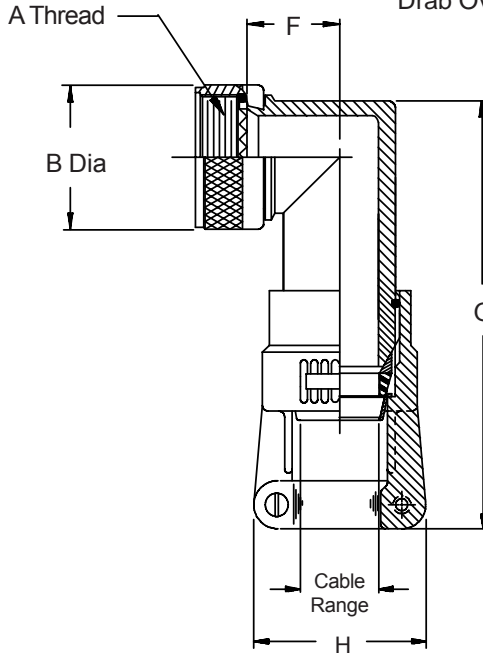

TABLE I

Shell Size	A Thread Class 2B	B Dia Max
9	M12 X 1 - 6H	.75 (19.1)
11	M15 X 1 - 6H	.85 (21.6)
13	M18 X 1 - 6H	1.00 (25.4)
15	M22 X 1 - 6H	1.15 (29.2)
17	M25 X 1 - 6H	1.25 (31.8)
19	M28 X 1 - 6H	1.40 (35.6)
21	M31 X 1 - 6H	1.55 (39.4)
23	M34 X 1 - 6H	1.65 (41.9)
25	M37 X 1 - 6H	1.85 (47.0)

TABLE II

Shell Size	Clamp Size		F		G	
	Min	Max	$\pm.062$	(1.6)	$\pm.062$	(1.6)
09	01	02	.438	(11.1)	3.141	(79.8)
11	01	03	.533	(13.5)	3.261	(82.8)
13	02	04	.548	(13.9)	3.281	(83.3)
15	02	05	.638	(16.2)	3.351	(85.1)
17	02	06	.823	(20.9)	3.441	(87.4)
19	03	07	.913	(23.2)	3.611	(91.7)
21	03	08	.913	(23.2)	3.611	(91.7)
23	03	09	1.063	(27.0)	3.721	(94.5)
25	04	10	1.063	(27.0)	3.721	(94.5)

TABLE III

Clamp Size	Cable Range		H Max
	Min	Max	
01	.062 (1.6)	.125 (3.2)	.80 (20.3)
02	.125 (3.2)	.250 (6.4)	1.00 (25.4)
03	.250 (6.4)	.375 (9.5)	1.10 (27.9)
04	.375 (9.5)	.500 (12.7)	1.20 (30.5)
05	.500 (12.7)	.625 (15.9)	1.25 (31.8)
06	.625 (15.9)	.750 (19.1)	1.40 (35.6)
07	.750 (19.1)	.875 (22.2)	1.50 (38.1)
08	.875 (22.2)	1.000 (25.4)	1.65 (41.9)
09	1.000 (25.4)	1.125 (28.6)	1.75 (44.5)
10	1.125 (28.6)	1.250 (31.8)	1.90 (48.3)

1. For complete dimensions see applicable Military Specification.
2. Metric dimensions (mm) are indicated in parentheses.
3. Cable range is defined as the accommodation range for the wire bundle or cable. Dimensions shown are not intended for inspection criteria.