

# RECEPTACLE ASSEMBLY – MIL-C-24217/1 WELDED TYPE

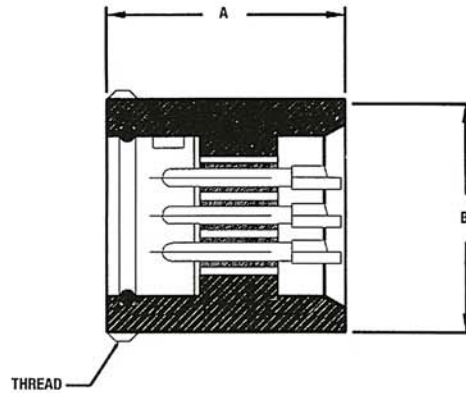

AMETEK SCP PART NUMBER	MILITARY PART NUMBER	"A" DIM	"B" DIM	THREAD 2A	NO. OF PINS
CR1443-1	M24217/1-001	1.62	1.12	1.250-12	3 EA. #16
CR1443-2	M24217/1-002	1.74	1.37	1.500-12	5 EA. #16
CR1443-3	M24217/1-003	1.87	1.58	1.750-12	9 EA. #16
CR1443-4	M24217/1-004	1.99	1.96	2.125-12	14 EA. #16
CR1443-5	M24217/1-005	2.12	2.34	2.500-12	24 EA. #16
CR1443-6	M24217/1-006	2.12	2.87	3.000-12	37 EA. #16
CR1443-7	M24217/1-007	2.41	3.75	3.750-12	48 EA. #16
CR1443-8	M24217/1-008	2.88	1.58	1.750-12	3 EA. #12
CR1443-9	M24217/1-009	2.88	2.00	2.125-12	5 EA. #12
CR1443-10	M24217/1-010	2.88	2.31	2.500-12	9 EA. #12
CR1443-11	M24217/1-011	2.88	2.00	2.125-12	3 EA. #8
CR1443-12	M24217/1-012	2.88	2.31	2.500-12	3 EA. #4
CR1443-13	M24217/1-013	2.88	2.31	2.500-12	3 EA. #12 3 EA. #8
CR1443-14	M24217/1-014	2.88	2.87	3.000-12	2 EA. #0 4 EA. #12
CR1443-15	M24217/1-015	1.62	1.12	1.250-12	5 EA. #16 (SPECIAL)

## CONFIGURATIONS AVAILABLE

Please refer to page 2.16 for above configurations available on the Receptacle Assembly – MIL-C-24217/1 Welded Type.