

PRESSURE-PROOF RECEPTACLE CAP ASSEMBLY – MIL-C-24217/10

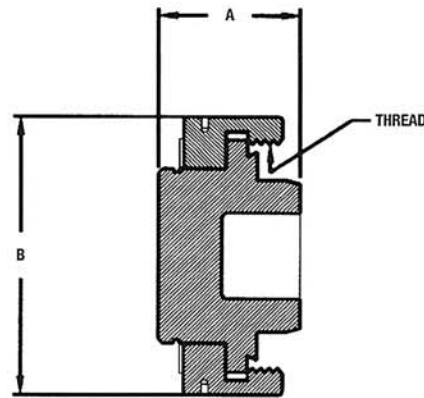

AMETEK SCP PART NUMBER	MILITARY PART NUMBER	"A" DIM	"B" DIM	THREAD 2B	FOR USE WITH RECEPTACLE TYPE
SC1464-1	M24217/10-001	1.13	1.27	1.250-12	3 EA. #16
SC1464-2	M24217/10-002	1.13	1.52	1.500-12	5 EA. #16
SC1464-3	M24217/10-003	1.22	1.77	1.750-12	9 EA. #16
SC1464-4	M24217/10-004	1.22	2.14	2.125-12	14 EA. #16
SC1464-5	M24217/10-005	1.22	2.52	2.500-12	24 EA. #16
SC1464-6	M24217/10-006	1.37	3.02	3.000-12	37 EA. #16
SC1464-7	M24217/10-007	1.54	3.77	3.750-12	48 EA. #16
SC1464-8	M24217/10-008	1.22	1.77	1.750-12	3 EA. #12
SC1464-9	M24217/10-009	1.22	2.14	2.125-12	5 EA. #12 & 3 EA. #8
SC1464-10	M24217/10-010	1.22	2.52	2.500-12	9 EA. #12, 3 EA. #4 & 3 EA. #12 With 3 EA. #8
SC1464-11	M24217/10-011	1.37	3.02	3.000-12	2 EA. #0 With 4 EA. #12
SC1464-12	M24217/10-012	1.13	1.39	1.375-12	8 EA. #16
SC1464-13	M24217/10-013	1.37	3.26	3.250-12	3 EA. #0